

MISSISSIPPI DEPARTMENT OF TRANSPORTATION
 COPYRIGHT LICENSE AGREEMENT

With the purchase of this map, the Mississippi Department of Transportation grants you the right to use the copyrighted map as set forth below.

The map is owned by the Mississippi Department of Transportation and is protected by the United States copyright laws and international protection. You are prohibited from making any other copyright material except that you may copy the map in whole or in part, without modification, provided the notice of copyright by the Mississippi Department of Transportation is displayed in a prominent visible location on each reproduction.

You have a royalty-free right to reproduce and distribute the copyrighted map as shown in its printed, unmodified, non-digital form in a permanent visible location on each reproduction.

Any modification of a map with this agreement and includes your name to use, copy, and distribute the map. Use of modified maps is strictly prohibited and is subject to prosecution under State and Federal laws.

This agreement is governed by the laws of the State of Mississippi, U.S. Federal Law, and the Mississippi Department of Transportation. Should you have any questions concerning this agreement, please write Mississippi Department of Transportation, Planning Division, Post Office Box 1800, Jackson, Mississippi 39201-1800.

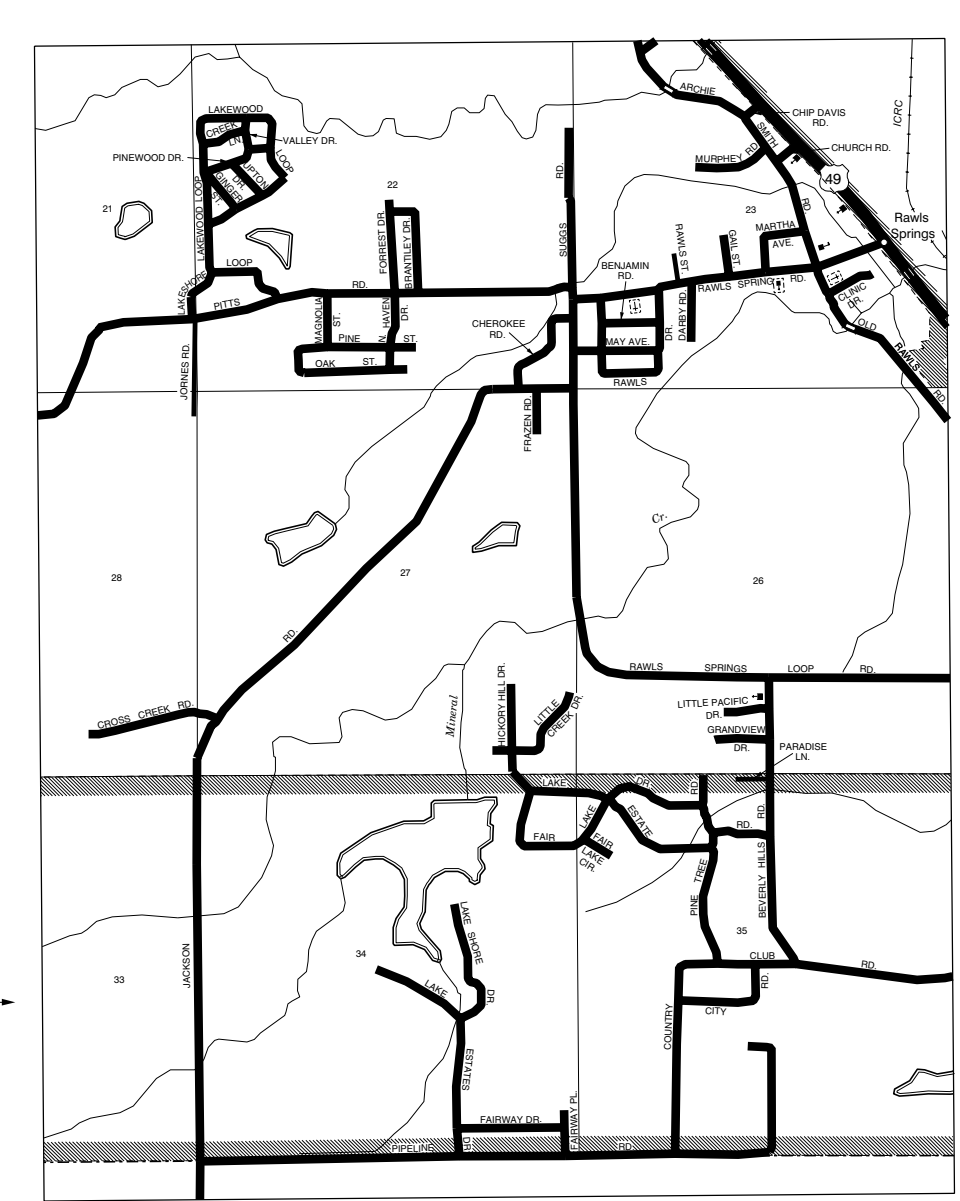
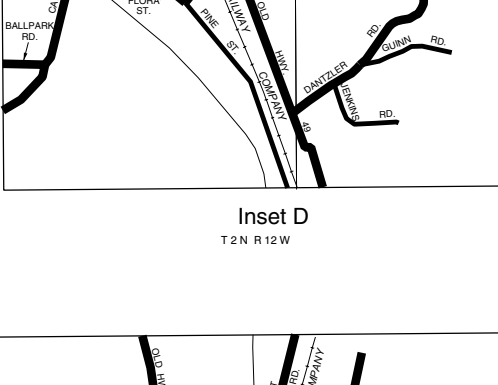
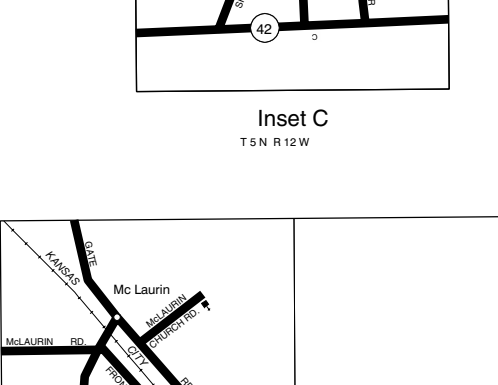
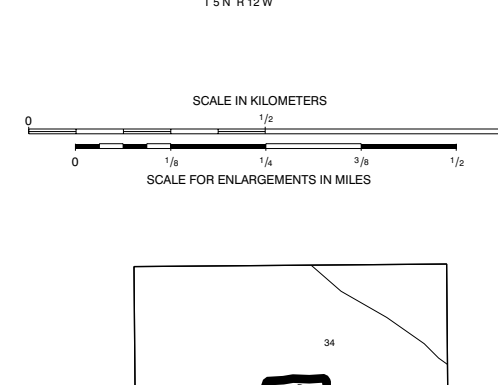
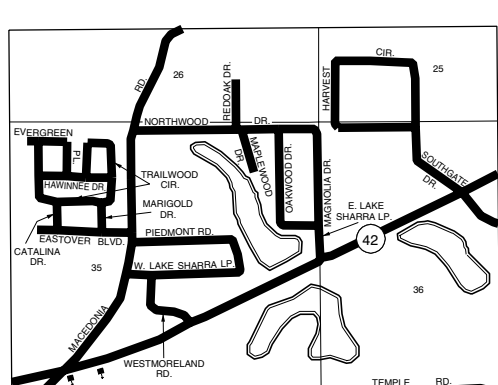
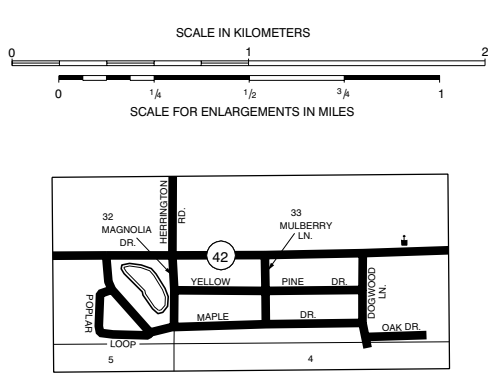
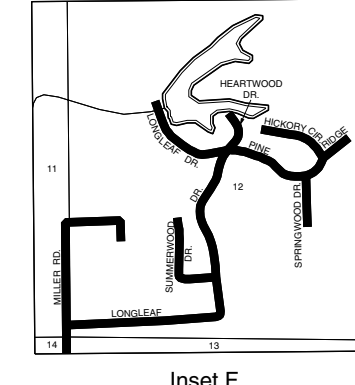

LEGEND

- | | |
|--|------------------------------------|
| ROADS AND ROADWAY FEATURES | NAVIGATION |
| UNIMPROVED ROAD | DOCK, PIER, OR LANDING |
| GRAVEL | LEVEE OR DIKE |
| PAVED ROAD | LEVEE OR DIKE WITH ROAD |
| UNIMPROVED HIGHWAY | |
| DIVIDED HIGHWAY | CITY AND VILLAGE CENTERS |
| INTERSTATE SYSTEM | COUNTY SEAT |
| CITY STREETS | OTHER CITIES AND VILLAGES |
| | MISCELLANEOUS |
| HIGHWAY BRIDGES | TRIANGULATION STATION |
| BRIDGE 50 FEET AND OVER | BENCH MARK WITH ELEVATION |
| DRAWBRIDGE | |
| FERRY (FREE OR TOLL) | PUBLIC SERVICE FACILITIES |
| HIGHWAY GRADE SEPARATION | OBSERVATION OR LOOKOUT TOWER |
| HIGHWAY INTERCHANGE | HIGHWAY GARAGE |
| | POST OFFICE |
| ROAD SYSTEM DESIGNATION | WEIGHT STATION |
| INTERSTATE NUMBERED | HOSPITAL |
| U.S. NUMBERED | SEWAGE DISPOSAL PLANT |
| STATE NUMBERED | COMMUNITY CENTER OR TOWN HALL |
| | NATIONAL PARK GARAGE |
| RAILROADS | FIRE STATION |
| RAILROAD STATION | PUBLIC LIBRARY |
| GRADE CROSSING | SANITARY LAND FILL |
| RAILROAD ABOVE | CORRECTIONAL INSTITUTION |
| RAILROAD BELOW | POLICE STATION |
| | GRAVEL PIT |
| | REST AREA |
| AIRPORTS | CONSERVATION AND RECREATION |
| MILITARY AIRPORT | MOTEL OR HOTEL |
| AIRPORT, LIMITED FACILITIES | CAMP OR LODGE |
| LANDING AREA OR STRIP (INCLUDING PRIVATE AIR FIELDS) | HISTORIC OR SCENIC SITE |
| AIRPORT, COMPLETE FACILITIES | FAIR GROUNDS OR RACE COURSE |
| AIRWAY LIGHT BEACON | SMALL PARK |
| | GOLF COURSE OR COUNTRY CLUB |
| DRAINAGE AND NATURAL FEATURES | INDUSTRIAL |
| NARROW STREAM | FACTORY OR INDUSTRY |
| DRAINAGE DITCH | SEASONAL INDUSTRY |
| LAKES AND RESERVOIRS | |
| OVERFLOW LAND | CHURCHES AND CEMETERIES |
| MARSH OR SWAMP LAND | CHURCH |
| | CEMETERY |
| | CHURCH WITH CEMETERY ADJACENT |
| BOUNDARIES | EDUCATION |
| STATE BOUNDARY | SCHOOL |
| COUNTY BOUNDARY | |
| BEAT LINE | MISCELLANEOUS STRUCTURES |
| SECTION LINE | ARMORY |
| NATIONAL OR STATE FOREST | FORT, ARMY CAMP |
| CONGRESSIONAL TOWNSHIP | |
| URBAN AREA COMPACT | |
| INCORPORATED PLACES | |
| UNINCORPORATED DELIMITED AREAS | |

GENERAL HIGHWAY MAP
FORREST COUNTY
 MISSISSIPPI

© 1996
 REVISED 04 / 2005
 MISSISSIPPI DEPARTMENT OF TRANSPORTATION
 PLANNING DIVISION
 IN COOPERATION WITH THE
 U.S. DEPARTMENT OF TRANSPORTATION
 FEDERAL HIGHWAY ADMINISTRATION
 TRANSVERSE MERCATOR PROJECTION,
 STATE PLANE COORDINATE SYSTEM 1983

DATA SOURCES
 1970 ASCS AERIAL PHOTOS
 1987 USGS DLG
 1990 MOOT FIELD INVENTORY
 2000 POPULATION 72,604
 1992 BEAT LINES

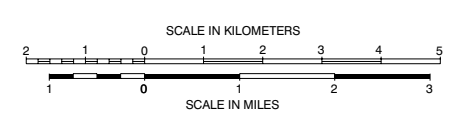
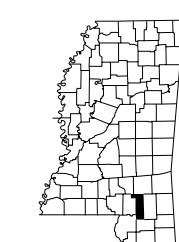

FORREST COUNTY MISSISSIPPI

18